

**ADDENDUM #1
TO
SPECIFICATION AND CONTRACT DOCUMENTS**

May 15, 2014

TO: ALL PLAN HOLDERS

FOR: ITB-021-2014
Metal Roof Overlay – Sprayfield Pole Barn

This addendum sets forth changes and/or additional information as referenced and is hereby made a part of and should be attached to the subject Specifications and Contract Documents.

Contractor must acknowledge receipt of all addenda with bid proposal on the form provided herein.

The purpose of addenda #1 is to provide changes and additional information.

REPLACE PAGE 4 OF 19 with the amended page 4.
Changes and additional information is noted in **RED**.

An electronic copy of the original pole barn plans is included for reference.

No. 1 Dated _____

Signature: _____

THIS FORM MUST BE INCLUDED WITH BID PROPOSAL

SEALED BIDS WILL BE ACCEPTED BY THE CITY OF LAKE CITY TO OVERLAY THE EXISTING ROOF WITH A METAL ROOF ON THE **36' X 200'** POLE BARN AT THE CITY OF LAKE CITY SPRAYFIELD SITE.

A. SCOPE OF WORK:

1. Remove 2 x 6 facial boards and replace with new 2 x 4 facial.
2. Replace rotten plywood as needed.
3. Install metal to cover plywood on both gable ends.
4. Install 29 gauge galvanized roof panels over pine 1 x 4 on 24" center with new flashing, eave drip, and ridge cap.
5. Metal on the east gable end to extend 8' from the peak.
- 6. The roof pitch shall be 4:12.**

B. LOCATION:

1. 3999 SW Sister's Welcome Road, Lake City, Florida 32025.

To schedule a site visit, please contact David Durrance, Sprayfield Supervisor, (386) 758-5463 ext. 295

[The balance of this page has been left intentionally blank]

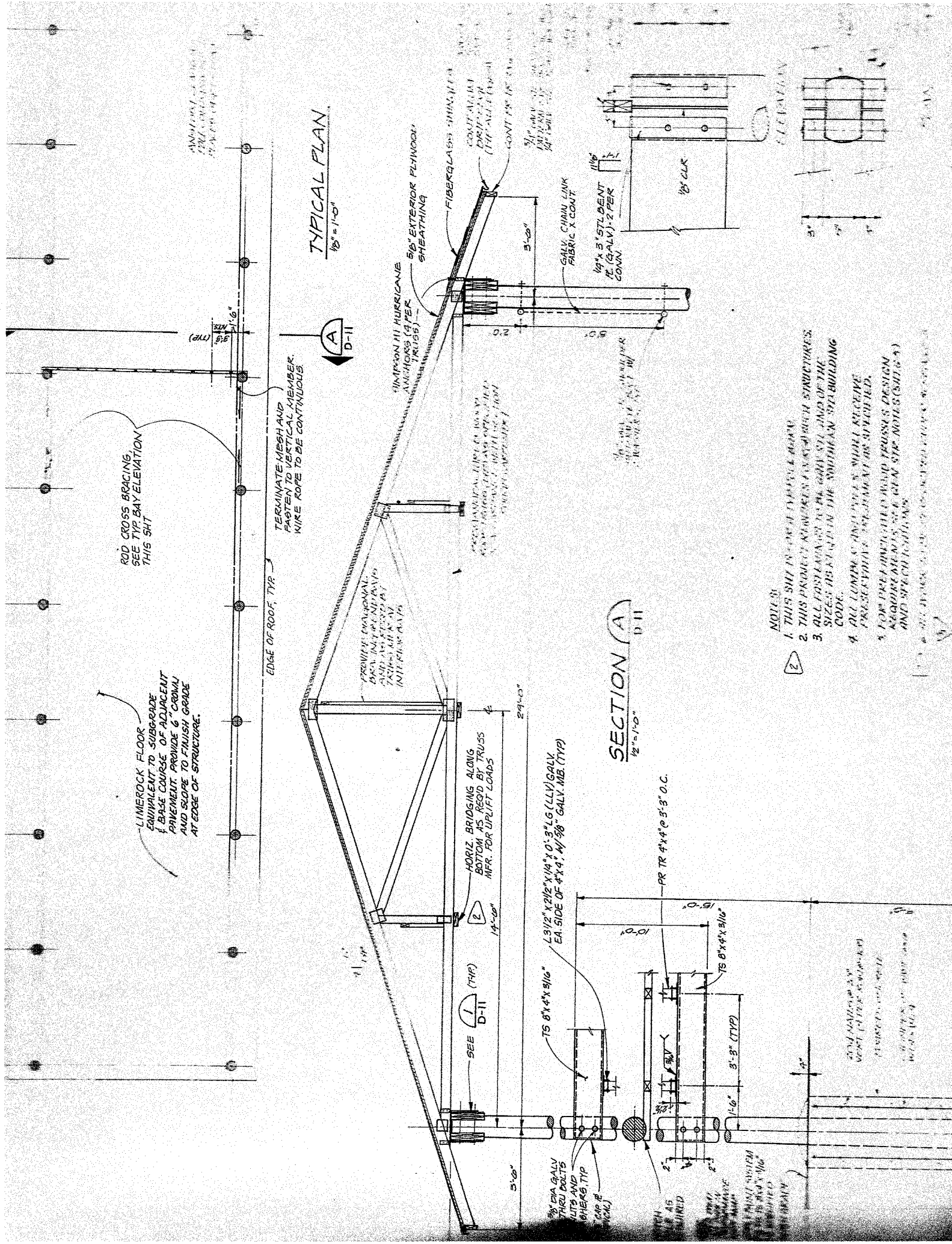

ROD CROSS BRACING
SEE TYP. BAY ELEVATION
THIS SHIT

LIMEROCK FLOOR
EQUIVALENT TO SUBGRADE
BASE COURSE OF ADJACENT
PAVEMENT. PROVIDE 6" CROWN
AND SLOPE TO FINISH GRADE
AT EDGE OF STRUCTURE.

EDGE OF ROOF, TYP.

TERMINATE MESH AND
FASTEN TO METAL MEMBER.
WIRE ROPE TO BE CONTINUOUS.

TYPICAL PLAN
1/2" = 1'-0"

(A)
D-II

MINIMUM #1 HURRICANE
ANCHORS (9 PER
TRUSS)

PROVIDE MINIMUM
BASE ANCHORS (9 PER
TRUSS) WITH 6" MIN.
DEVELOPMENT LENGTH

HORIZ. BRIDGING ALONG
BOTTOM AS REQ'D BY TRUSS
MFR. FOR UPLIFT LOADS

2x12 (TRUSS)
EA. SIDE OF 4x4, 1/2" GALV. MB. (TYP)

SECTION (A)
1/2" = 1'-0"

PR TR 4x4 @ 3'-3" O.C.

TS 8x4x5/16"

3/8" DIA GALV
THRU BOLTS
WITH WILD
NUTS AND
WASHERS TYP.

1/2" DIA GALV
THRU BOLTS
WITH WILD
NUTS AND
WASHERS TYP.

1/2" DIA GALV
THRU BOLTS
WITH WILD
NUTS AND
WASHERS TYP.

10'-0"

15'-0"

3'-3" (TYP)

1'-6"

2'-0"

2'-0"

2'-0"

2'-0"

2'-0"

2'-0"

2'-0"

2'-0"

2'-0"

2'-0"

2'-0"

2'-0"

2'-0"

2'-0"

2'-0"

2'-0"

2'-0"

2'-0"

2'-0"

2'-0"

2'-0"

2'-0"

2'-0"

2'-0"

2'-0"

2'-0"

2'-0"

2'-0"

2'-0"

2'-0"

2'-0"

2'-0"

2'-0"

- NOTE: 1. THIS SHIT IS FOR THE TRUSS ONLY.
 2. THIS PROJECT INVOLVES A COMPLEX STRUCTURE.
 3. ALL FASTENERS TO BE GALV. STEEL END OF THE
 STRUCTURE.
 4. ALL DIMENSIONS ARE TO FACE UNLESS SPECIFIED.
 5. FOR PREPARED BY TRUSS DESIGN
 REQUIREMENTS SEE GEN. SPEC. NOTES (SHEET 4)
 AND SPEC. DETAILS.

2

