

PRICE CREEK WATER TREATMENT PLANT (PCWTP) NEW ACCESS ROAD

CONSTRUCTION PLANS

STA 10+00.00 TO 24+76.85

FOR:
STEVE ROBERTS
DIRECTOR OF PCWTP
144 SE OZONE LOOP
Lake City, FL 32055
Phone: (386) 466-3350

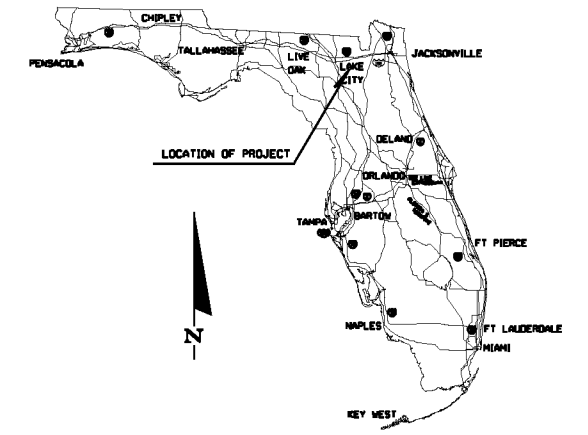

LEGEND	
EXISTING	PROPOSED
CONCRETE MONUMENT FOUND	TELEPHONE POLE
IRON PIPE FOUND	TELEPHONE MANHOLE
ELECTRIC METER	ELECTRIC MANHOLE
ELECTRIC MANHOLE	ELECTRIC METER
LIGHT STANDARD	LIGHT
POWER POLE	STANDARD POWER POLE
SHARED POWER POLE W/ TRANSFORMER	POWER POLE SHARED
SHARED POWER POLE	POWER POLE SHARED W/TRANSFORMER
TELEPHONE POLE	GAS METER
REDUCER	GAS VALVE
WATER METER	WATER METER
WATER VALVE	WATER VALVE
FIRE HYDRANT	WATER REDUCER
BACKFLOW PREVENTER	WATER TEE
SANITARY SEWER VALVE	WATER 90° BEND
SANITARY MANHOLE	SINGLE WATER SERVICE
STORMWATER MANHOLE	DOUBLE WATER SERVICE
FDOT STORMWATER MANHOLE	FIRE HYDRANT
GROUND CONTOUR	BACKFLOW PREVENTER
D.O.T. MARKER FOUND	SANITARY MANHOLE
GAS METER	SANITARY VALVE
GAS VALVE	SANITARY SINGLE SERVICE
SOIL BORING LOCATION	SANITARY DOUBLE SERVICE
SINGLE POST SIGN	GROUND CONTOUR
BENCH MARK	DITCH BLOCK
SECTION CORNER	STORMWATER MANHOLE
RIGHT OF WAY	FLOW ARROW
PROPERTY LINE	HANDICAP PARKING
	MITERED END
	SIGN
	RIGHT OF WAY

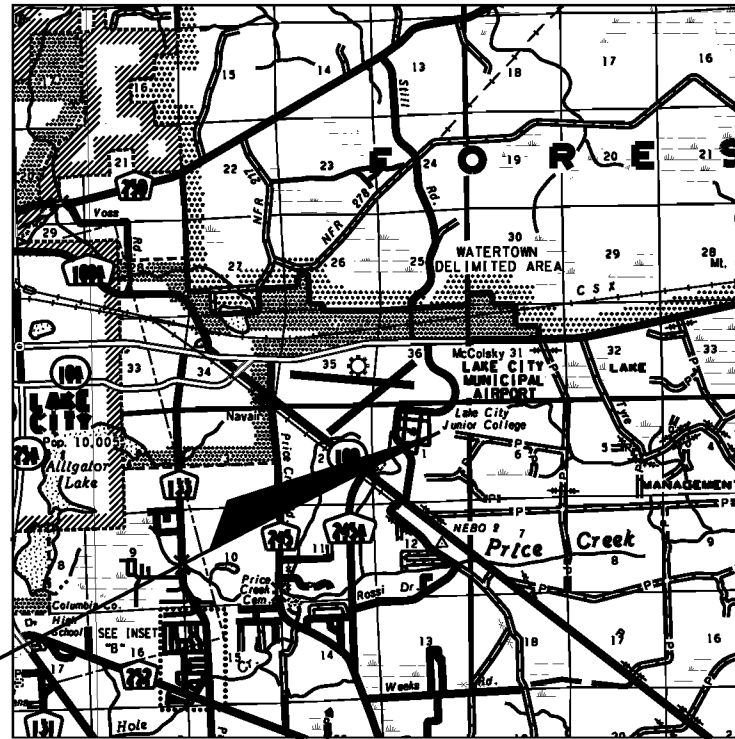

PROJECT SITE

LOCATION MAP

SECTION 1 TOWNSHIP 4 SOUTH, RANGE 17 EAST
COLUMBIA COUNTY, FLORIDA

FINAL PLANS

INDEX OF SHEETS

KEY1	KEY SHEET
DET1	GENERAL NOTES AND TYPICAL SECTION
DET2	MISCELLANEOUS NOTES AND DETAILS
PP1 - PP3	PLAN / PROFILE SHEETS
XSC1 - XSC5	CROSS SECTION SHEETS
WET1	WETLAND IMPROVEMENT PLAN
SWPPP1 - SWPPP2	STORMWATER POLLUTION PREVENTION PLAN
	APPLICABLE FDOT STANDARDS

CES PROJECT ID:
2012-002

ABBREVIATIONS

PL	PROPERTY LINE	IP	IRON PIPE
CL	CENTER LINE	MH	MANHOLE
BL	BASE LINE	G	GAS
SAN	SANITARY SEWER	UC	UNDERGROUND CABLE
ST	STORM SEWER	OC	OVERHEAD CABLE
E	ELECTRIC	W	WATER LINE
OHE	OVERHEAD ELECTRIC	HDPE	HIGH-DENSITY POLYETHYLENE
UG	UNDERGROUND ELECTRIC	RCP	REINFORCED CONCRETE PIPE-ROUND
OHT	OVERHEAD TELEPHONE	RCPA	REINFORCED CONCRETE PIPE-ARC
UT	UNDERGROUND TELEPHONE	RCPE	REINFORCED CONCRETE PIPE-ELLIPTICAL
R	RADIUS	CMP	CORRUGATED METAL PIPE-ROUND
CO	CLEANOUT	CMPA	CORRUGATED METAL PIPE-ARC
BM	BENCH MARK	BCCMP	BITUMINOUS COATED CORRUGATED METAL PIPE
IE	INVERT ELEVATION	BCCSP	BITUMINOUS COATED CORRUGATED STEEL PIPE
LF	LINEAR FEET		

CES

Crews Engineering Services, LLC

CERTIFICATE OF AUTHORIZATION
NO. 28022

P.O. BOX 970
LAKE CITY, FL 32056
PHONE: 386.754.4085

BRETT A. CREWS, P. E. 65592

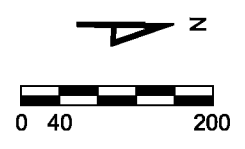
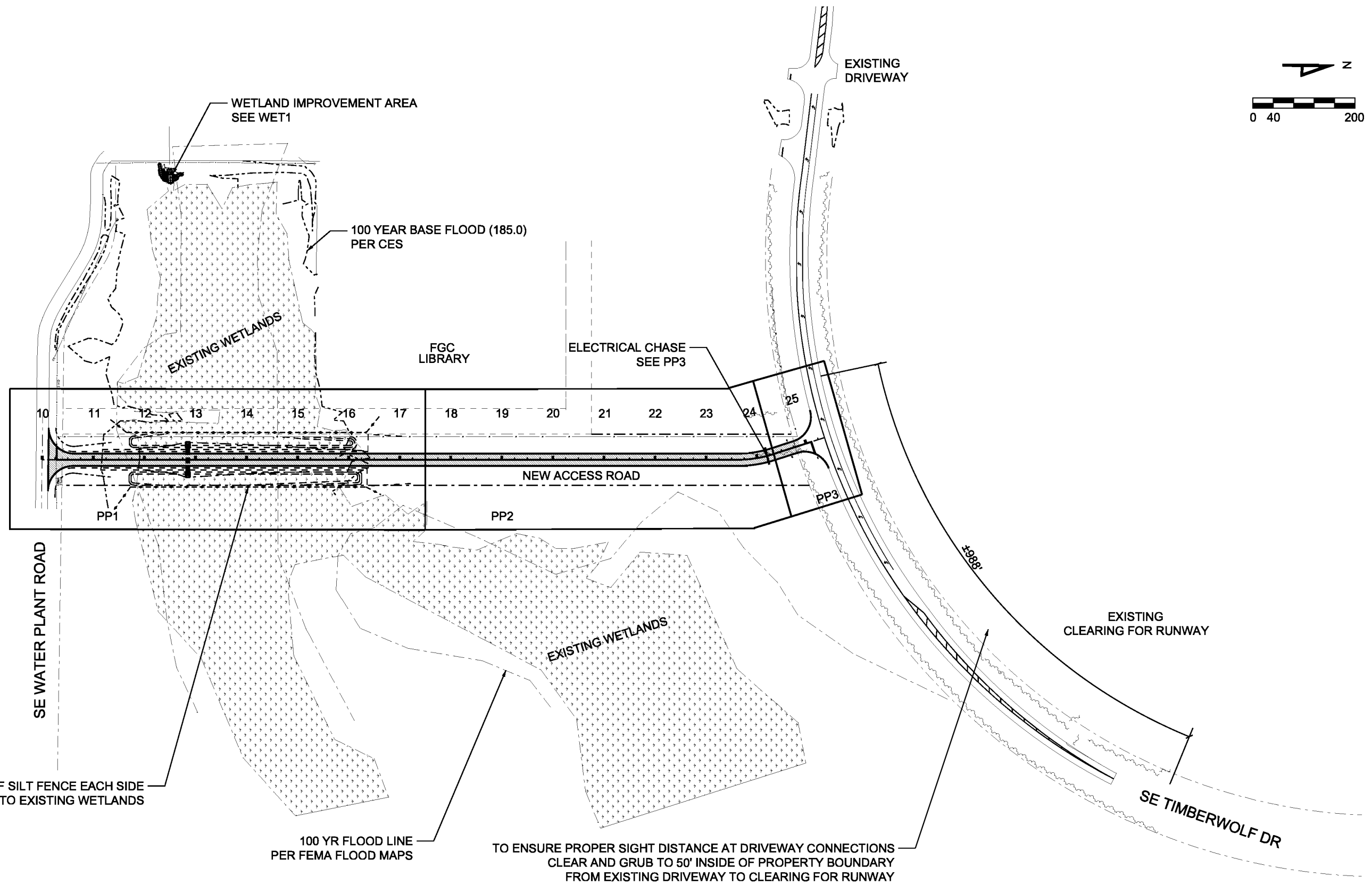

REVISIONS					
DATE	BY	DESCRIPTION	DATE	BY	DESCRIPTION



CERTIFICATE OF AUTHORIZATION
NO. 28022
P.O. BOX 970
LAKE CITY, FL 32056
PHONE: 386.754.4085

Brett A. Crews, P.E. 65592

DRAWN BY:
BC
APPROVED BY:
BC

**PCWTP
NEW ACCESS ROAD**

**KEY SHEET AND
OVERALL SITE PLAN**

PROJECT NO.:
2012-002

SHEET:
KEY1

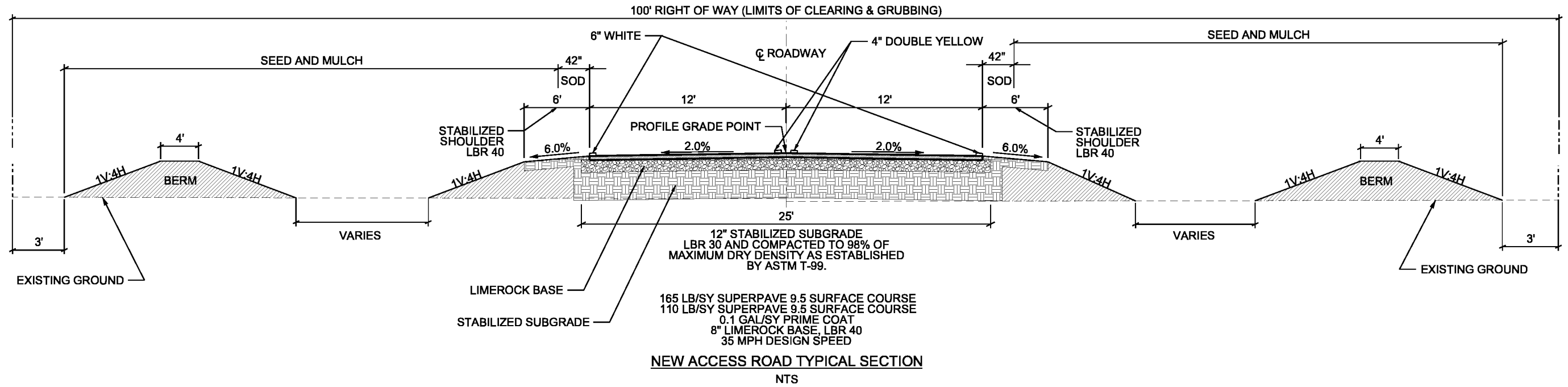

NEW ACCESS ROAD TYPICAL SECTION
NTS

GENERAL NOTES

1. THE CONTRACTOR SHALL VERIFY ALL EXISTING CONDITIONS AND DIMENSIONS AT THE JOB SITE TO INSURE THAT ALL NEW WORK WILL FIT IN THE MANNER INTENDED ON THE PLANS. SHOULD ANY CONDITIONS EXIST THAT ARE CONTRARY TO THOSE SHOWN ON THE PLANS, THE CONTRACTOR SHALL NOTIFY THE ENGINEER OF SUCH DIFFERENCES IMMEDIATELY & PRIOR TO PROCEEDING WITH THE WORK.
2. THE CONTRACTOR SHALL MAINTAIN THE CONSTRUCTION SITE AT ALL TIMES IN A SECURE MANNER. ALL OPEN TRENCHES AND EXCAVATED AREAS SHALL BE PROTECTED FROM ACCESS BY THE GENERAL PUBLIC.
3. ANY PUBLIC LAND CORNER WITHIN THE LIMITS OF CONSTRUCTION IS TO BE PROTECTED. IF A CORNER MONUMENT IS IN DANGER OF BEING DESTROYED AND HAS NOT BEEN PROPERLY REFERENCED, THE CONTRACTOR SHOULD NOTIFY THE ENGINEER.
4. THE SURFACE WATER MANAGEMENT SYSTEM SHALL BE CONSTRUCTED IN ACCORDANCE WITH SRWMD RULES AND REGULATIONS (CH. 40B-4 F.A.C.).
5. EXISTING DRAINAGE STRUCTURES WITHIN THE CONSTRUCTION LIMITS SHALL BE REMOVED, UNLESS OTHERWISE SPECIFIED IN THE PLANS.
6. THE CONTRACTOR SHALL UTILIZE ALL EXCESS EARTH ON SITE AS DIRECTED BY THE ENGINEER.
7. ALL SITE CONSTRUCTION SHALL BE IN ACCORDANCE WITH THE COLUMBIA COUNTY LAND DEVELOPMENT REGULATIONS.
8. SITE CONTRACTOR SHALL COORDINATE ALL WORK WITH OTHER CONTRACTORS WITHIN PROJECT LIMITS.
9. ALL PROPOSED CONSTRUCTION SHALL CONFORM TO CURRENT FDOT DESIGN STANDARDS AND FDOT STANDARD SPECIFICATIONS FOR ROAD AND BRIDGE CONSTRUCTION.
10. ALL STORM PIPES SHALL HAVE A MINIMUM COVER OF 9" UNLESS OTHERWISE SHOWN IN THESE PLANS. LIMEROCK BACKFILL SHALL BE USED IF PIPE UNDER PAVEMENT HAS LESS THAN 12" COVER.
11. ALL NEW TRAFFIC SIGNAGE AND PAVEMENT MARKINGS SHALL CONFORM TO THE CURRENT MANUAL ON UNIFORM TRAFFIC CONTROL DEVICES AND THE CURRENT FDOT DESIGN STANDARDS.

GENERAL NOTES CONT.

12. MAINTENANCE OF TRAFFIC SHALL BE IN ACCORDANCE WITH CURRENT FDOT DESIGN STANDARDS. THE CONTRACTOR SHALL MEET ON SITE WITH FDOT FOR APPROVAL OF A MAINTENANCE OF TRAFFIC PLAN PRIOR TO BEGINNING WORK WITHIN FDOT RIGHT OF WAY.
13. CONTRACTOR SHALL CONTACT THE CITY OF LAKE CITY AND C.E.S. TO PERFORM THE FOLLOWING SITE INSPECTIONS:
A) EROSION AND SEDIMENT CONTROL - ONCE IN PLACE PRIOR TO BEGINNING CONSTRUCTION
B) CLEARING AND GRUBBING - VISUAL INSPECTION
14. CONTRACTOR SHALL CONTACT SRWMD AND CITY OF LAKE CITY ENGINEER (JASON SPARKS, 386.466.3359) 48 HOURS PRIOR TO BEGINNING CONSTRUCTION.
15. CONTRACTOR SHALL PROVIDE SAMPLING AND TESTING RESULTS FROM A CERTIFIED SOILS TESTING LAB FOR THE FOLLOWING:
1. EMBANKMENT / BORROW: PROCTOR, LBR, DENSITY
2. STORM STRUCTURE AND PIPES: DENSITY
3. LIMEROCK BASE: DENSITY AND THICKNESS
4. ASPHALTIC CONCRETE: DAILY ASPHALT ROADWAY REPORTS
TESTING FREQUENCY SHALL MEET CURRENT FDOT STANDARDS. THESE REQUIREMENTS ARE MINIMUMS. ENGINEER MAY REQUEST ADDITIONAL INFORMATION BASED ON CURRENT FDOT STANDARDS.

EROSION CONTROL NOTES

1. CONTRACTORS SHALL ADHERE TO THE STORM WATER POLLUTION PREVENTION PLAN, EROSION AND SEDIMENT CONTROL REGULATIONS AS SET BY SRWMD AND OTHER GOVERNING AUTHORITIES AND USE (AS A MINIMUM) THE MEASURES DESCRIBED IN THESE PLANS.
2. ALL EROSION CONTROL MEASURES SHALL BE IMPLEMENTED AND WATER MANAGEMENT FACILITIES SHALL BE INSTALLED PRIOR TO ANY OTHER CONSTRUCTION.
3. CONTRACTOR IS RESPONSIBLE FOR IMPLEMENTING ADDITIONAL MEASURES AS REQUIRED FOR PROPER EROSION AND SEDIMENT CONTROL. THE CONTRACTOR SHOULD USE BMP'S IN THE FLORIDA EROSION AND SEDIMENT CONTROL INSPECTOR'S MANUAL TO IMPLEMENT A PLAN THAT WILL WORK AND MEET ACTUAL FIELD CONDITIONS.
4. SEDIMENT AND EROSION CONTROL MEASURES SHALL NOT BE REMOVED UNTIL ALL CONSTRUCTION IS COMPLETE AND UNTIL A PERMANENT GROUND COVER HAS BEEN ESTABLISHED.
5. ALL OPEN DRAINAGE SWALES SHALL BE GRASSED IMMEDIATELY AS REQUIRED TO CONTROL EROSION.

EROSION CONTROL NOTES CONT.

6. SILT FENCES SHALL BE LOCATED ON SITE TO PREVENT SEDIMENT AND EROSION FROM LEAVING PROJECT LIMITS. SILT FENCE SHALL BE CLEANED OR REPLACED WHEN SILT BUILDS UP TO WITHIN ONE FOOT OF TOP OF SILT FENCE.
7. DURING CONSTRUCTION AND AFTER CONSTRUCTION IS COMPLETE, ALL STRUCTURES SHALL BE CLEANED OF ALL DEBRIS AND EXCESS SEDIMENT.
8. ALL DISTURBED AREAS SHALL BE STABILIZED IMMEDIATELY TO PREVENT EROSION. SLOPES GREATER THAN 1V:4H SHALL BE STABILIZED WITH SOD. STAPLE SOD SHALL BE USED ON SLOPES GREATER THAN 1V:2H. ALL DISTURBED AREAS NOT SODDED SHALL BE SEEDED WITH A MIXTURE OF LONG-TERM VEGETATION AND QUICK-GROWING SHORT-TERM VEGETATION FOR THE FOLLOWING CONDITIONS: FOR THE MONTHS FROM SEPTEMBER THROUGH MARCH, THE MIX SHALL CONSIST OF 70 POUNDS PER ACRE OF LONG-TERM SEED AND 20 POUNDS PER ACRE OF WINTER RYE. FOR THE MONTHS OF APRIL THROUGH AUGUST, THE MIX SHALL CONSIST OF 70 POUNDS PER ACRE OF LONG-TERM SEED AND 20 POUNDS PER ACRE OF MILLET.
9. ALL STABILIZATION PRACTICES SHALL BE INITIATED AS SOON AS PRACTICABLE IN AREAS OF THE JOB WHERE CONSTRUCTION ACTIVITIES HAVE TEMPORARILY OR PERMANENTLY STOPPED, BUT IN NO CASE SHALL THE DISTURBED AREA BE LEFT UNPROTECTED FOR MORE THAN THREE (3) DAYS.
10. LOADED HAUL TRUCKS SHALL BE COVERED WITH TARPS AND EXCESS DIRT REMOVED DAILY.
11. THIS PROJECT SHALL COMPLY WITH ALL APPLICABLE WATER QUALITY STANDARDS.
12. QUALIFIED PERSONNEL SHALL INSPECT THE STOCKPILE AREAS, SILT FENCE, CONSTRUCTION ENTRANCE, AND ALL DISTURBED AREAS THAT HAVE NOT BEEN FINALLY STABILIZED, AT LEAST ONCE EVERY SEVEN (7) CALENDAR DAYS AND WITHIN 24 HOURS AFTER A STORM OF 0.5 INCHES OR GREATER. CORRECTIVE ACTIONS SHALL BE TAKEN IMMEDIATELY.
13. CONTRACTOR IS RESPONSIBLE FOR THE CONSTRUCTION AND MAINTENANCE OF ALL EROSION AND SEDIMENT CONTROLS DURING PROPOSED CONSTRUCTION.
14. THE CONTRACTOR SHALL INSTALL A TEMPORARY GRAVEL CONSTRUCTION ENTRANCE PER THE FLORIDA STORMWATER EROSION AND SEDIMENT CONTROL INSPECTOR'S MANUAL. AT LOCATIONS WHERE VEHICLES WILL BE ENTERING AND EXITING THE SITE. REFER TO THE SWPPP.

REVISIONS

DATE	BY	DESCRIPTION	DATE	BY	DESCRIPTION



CERTIFICATE OF AUTHORIZATION
NO. 28022

P.O. BOX 970
LAKE CITY, FL 32056
PHONE: 386.754.4085

Brett A. Crews, P.E. 65592

DRAWN BY:

BC

APPROVED BY:

BC

PCWTP
NEW ACCESS ROAD

GENERAL NOTES
AND TYPICAL SECTIONS

PROJECT NO.:

2012-002

SHEET:

DET1

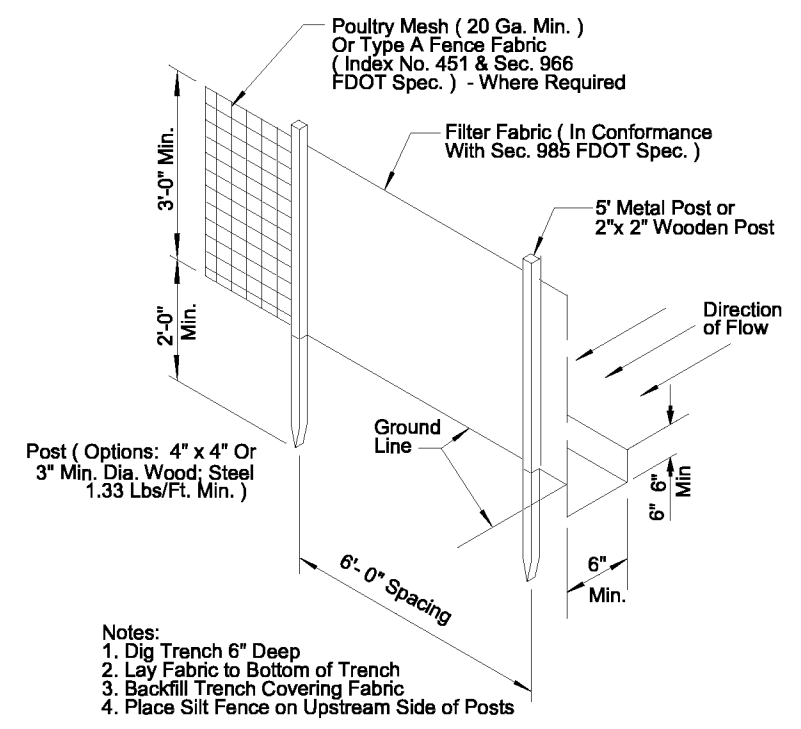
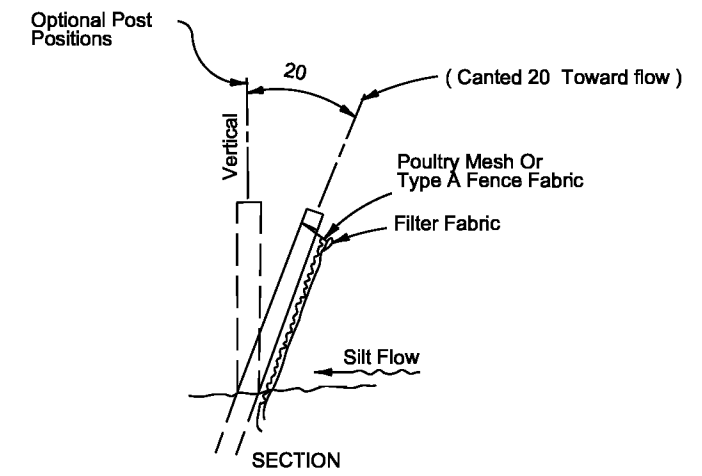
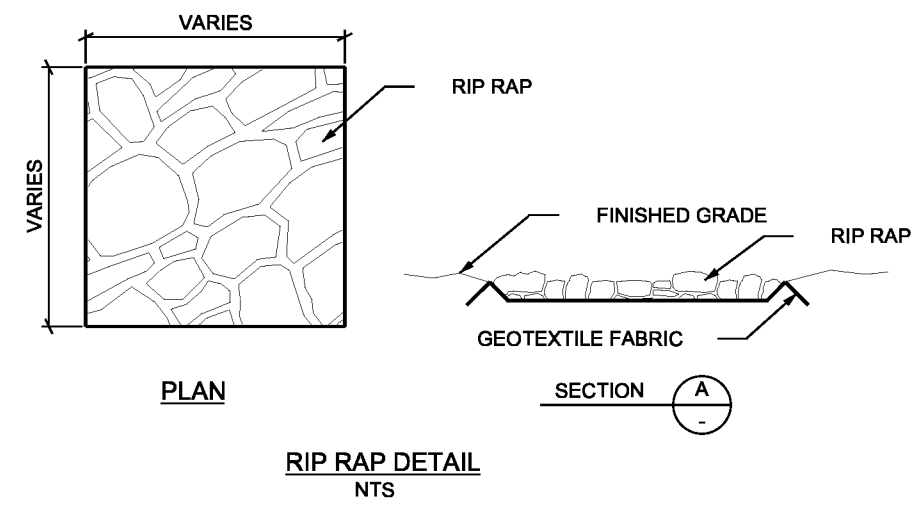
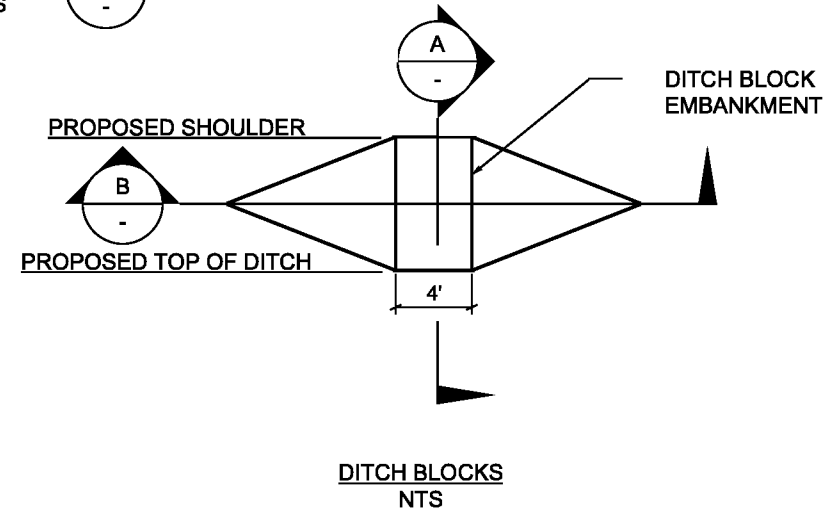
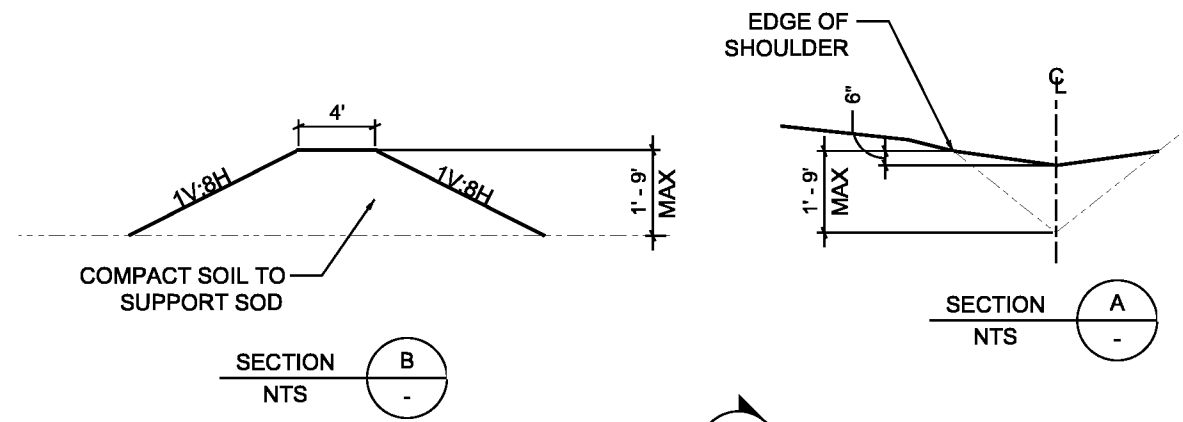

- Notes:
 1. Dig Trench 6" Deep
 2. Lay Fabric to Bottom of Trench
 3. Backfill Trench Covering Fabric
 4. Place Silt Fence on Upstream Side of Posts

TYPE IV SILT FENCE

AS COMPARED TO TYPE III SILT FENCE, TYPE IV FENCE HAS GREATER STRENGTH AND HEIGHT WHICH REDUCES THE POSSIBILITY OF SEDIMENT AND WATER FROM OVERTOPPING THE FENCE. AS A RESULT, AVOID USING TYPE IV FENCE IN AREAS WHERE THE DETAINED WATER WOULD BACK INTO TRAVEL LANES OR OFF THE RIGHT OF WAY.

REVISIONS					
DATE	BY	DESCRIPTION	DATE	BY	DESCRIPTION



CERTIFICATE OF AUTHORIZATION
 NO. 28022
 P.O. BOX 970
 LAKE CITY, FL 32056
 PHONE: 386.754.4085

Brett A. Crews, P.E. 65592

DRAWN BY:
BC
 APPROVED BY:
BC

**PCWTP
 NEW ACCESS ROAD**
**MISCELLANEOUS NOTES
 AND DETAILS**

PROJECT NO.:
2012-002
 SHEET:
DET2

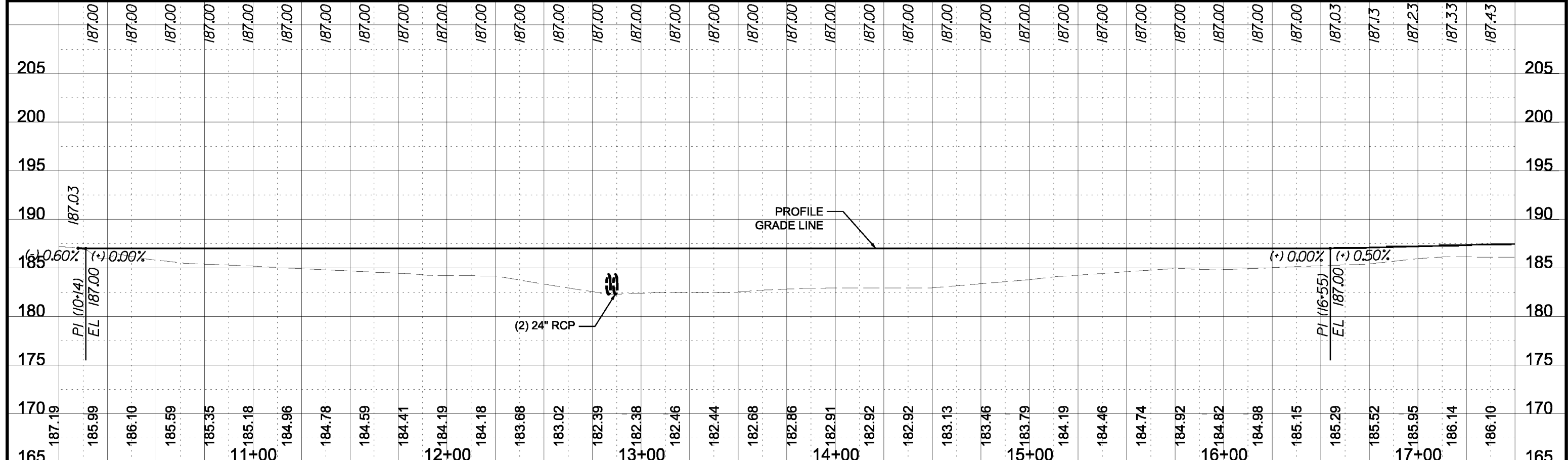
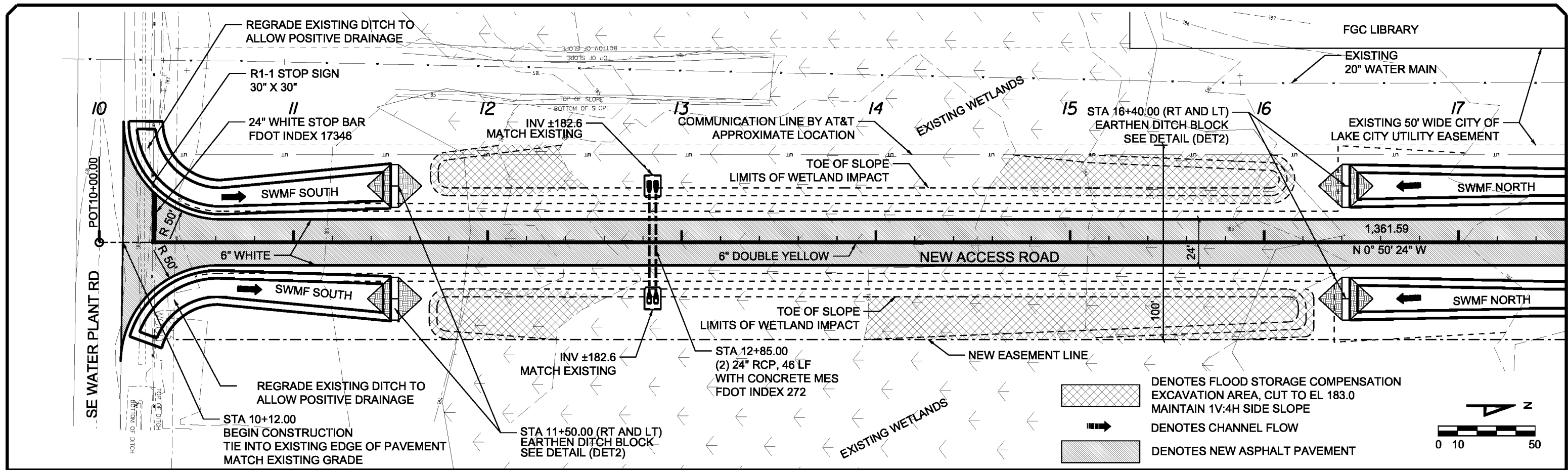

REVISIONS					
DATE	BY	DESCRIPTION	DATE	BY	DESCRIPTION

CES
 Crews Engineering Services, LLC

CERTIFICATE OF AUTHORIZATION
 NO. 28022
 P.O. BOX 970
 LAKE CITY, FL 32056
 PHONE: 386.754.4085

DRAWN BY:
BC

APPROVED BY:
BC

Brett A. Crews, P.E. 65592

**PCWTP
 NEW ACCESS ROAD**

**PLAN / PROFILE
 SHEETS**

CES PROJECT NO.:
2012-002

SHEET:
PP1

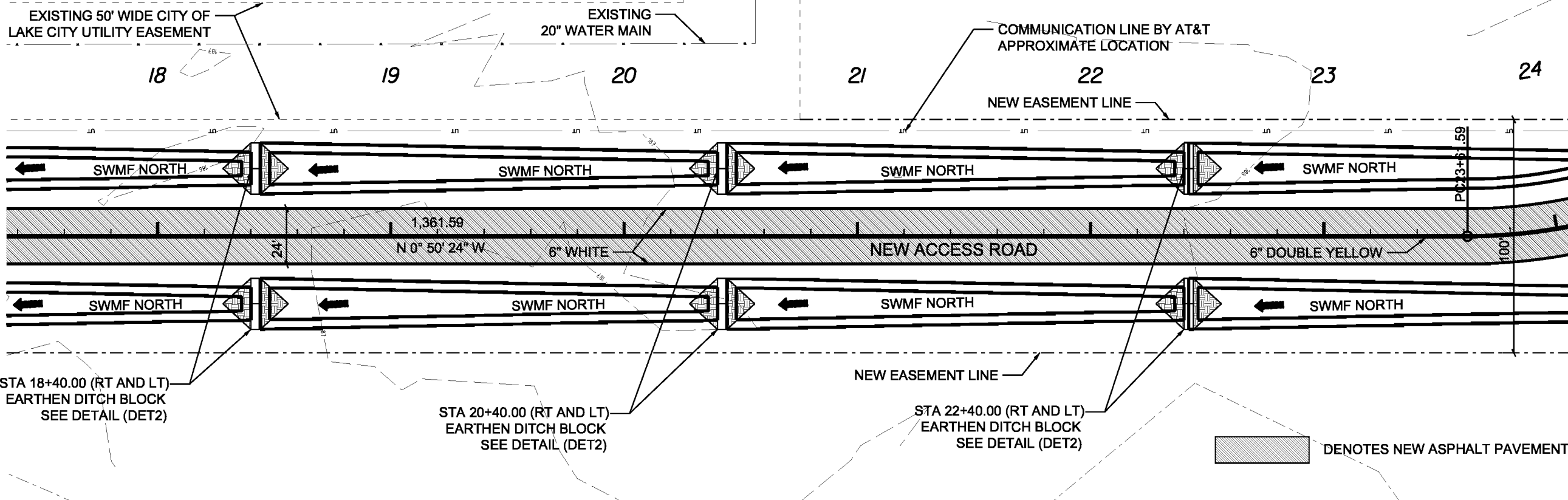

CURB DATA
 DELTA = 17° 55' 37" (LT)
 D = 24° 54' 40"
 T = 36.28
 L = 71.96
 R = 230.00
 C = 71.67
 CB = N 9° 48' 13" W
 PC STA = 23+61.59
 PI STA = 23+97.87
 PT STA = 24+33.55

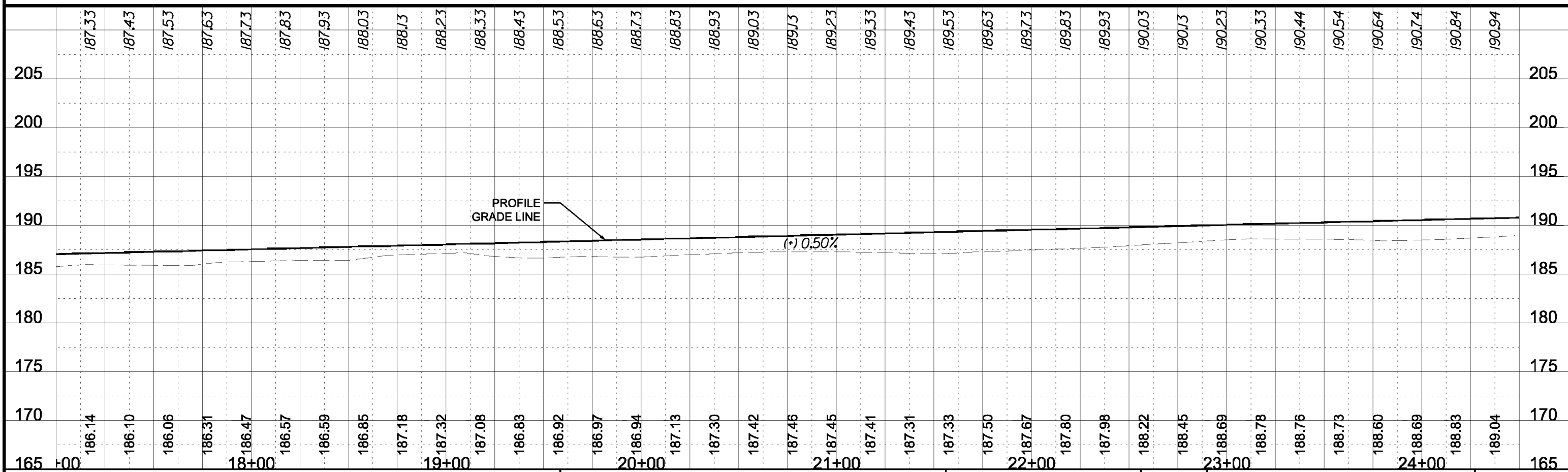
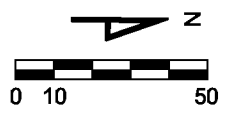

REVISIONS					
DATE	BY	DESCRIPTION	DATE	BY	DESCRIPTION



CERTIFICATE OF AUTHORIZATION
 NO. 28022
 P.O. BOX 970
 LAKE CITY, FL 32056
 PHONE: 386.754.4085

Brett A. Crews, P.E. 65592

DRAWN BY:
BC
 APPROVED BY:
BC

**PCWTP
 NEW ACCESS ROAD**
**PLAN / PROFILE
 SHEETS**

CES PROJECT NO.:
2012-002
 SHEET:
PP2

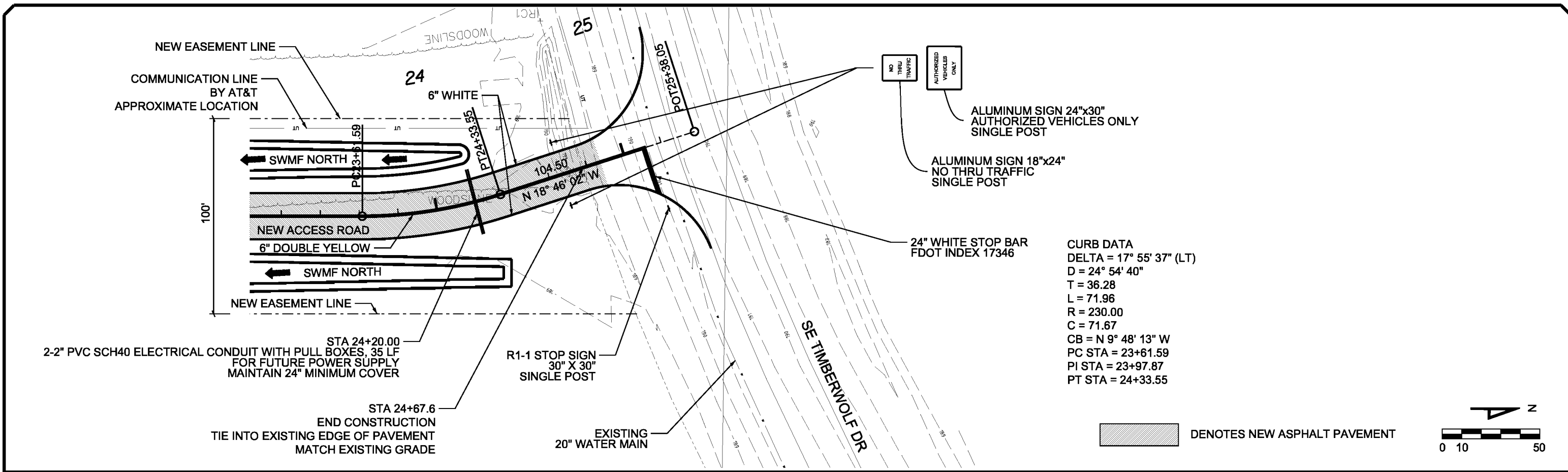

CURB DATA
 DELTA = 17° 55' 37" (LT)
 D = 24° 54' 40"
 T = 36.28
 L = 71.96
 R = 230.00
 C = 71.67
 CB = N 9° 48' 13" W
 PC STA = 23+61.59
 PI STA = 23+97.87
 PT STA = 24+33.55

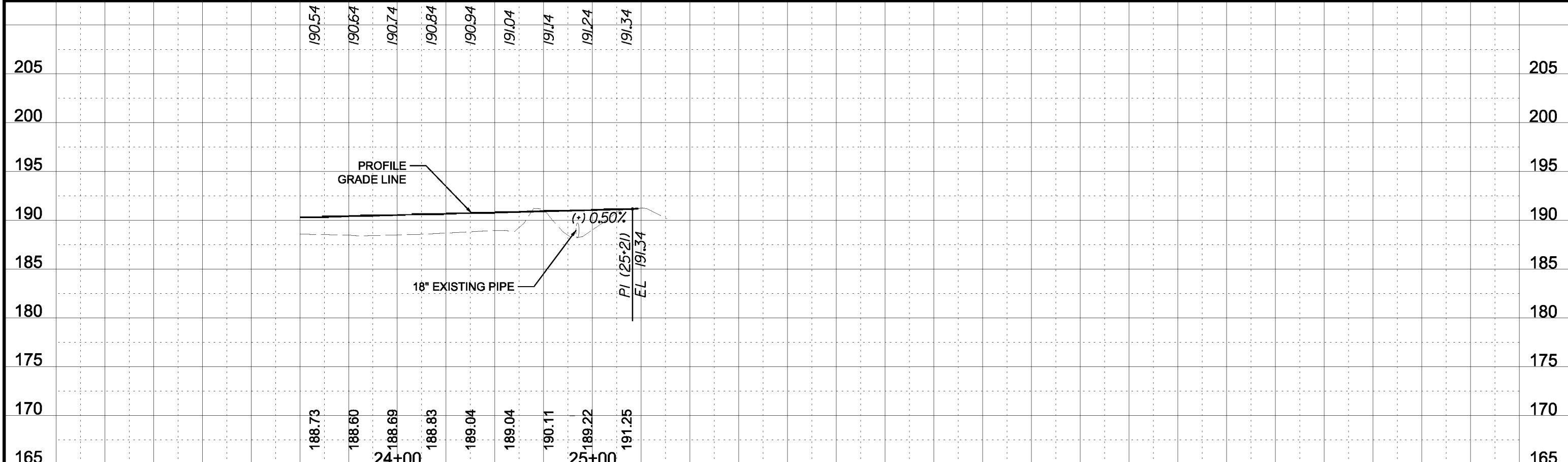
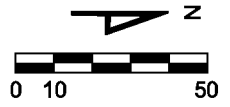

REVISIONS					
DATE	BY	DESCRIPTION	DATE	BY	DESCRIPTION

CES
 Crews Engineering Services, LLC

CERTIFICATE OF AUTHORIZATION
 NO. 28022
 P.O. BOX 970
 LAKE CITY, FL 32056
 PHONE: 386.754.4085

Brett A. Crews, P.E. 65592

DRAWN BY:
 BC

APPROVED BY:
 BC

**PCWTP
 NEW ACCESS ROAD**

**PLAN / PROFILE
 SHEETS**

CES PROJECT NO.:
 2012-002

SHEET:
 PP3

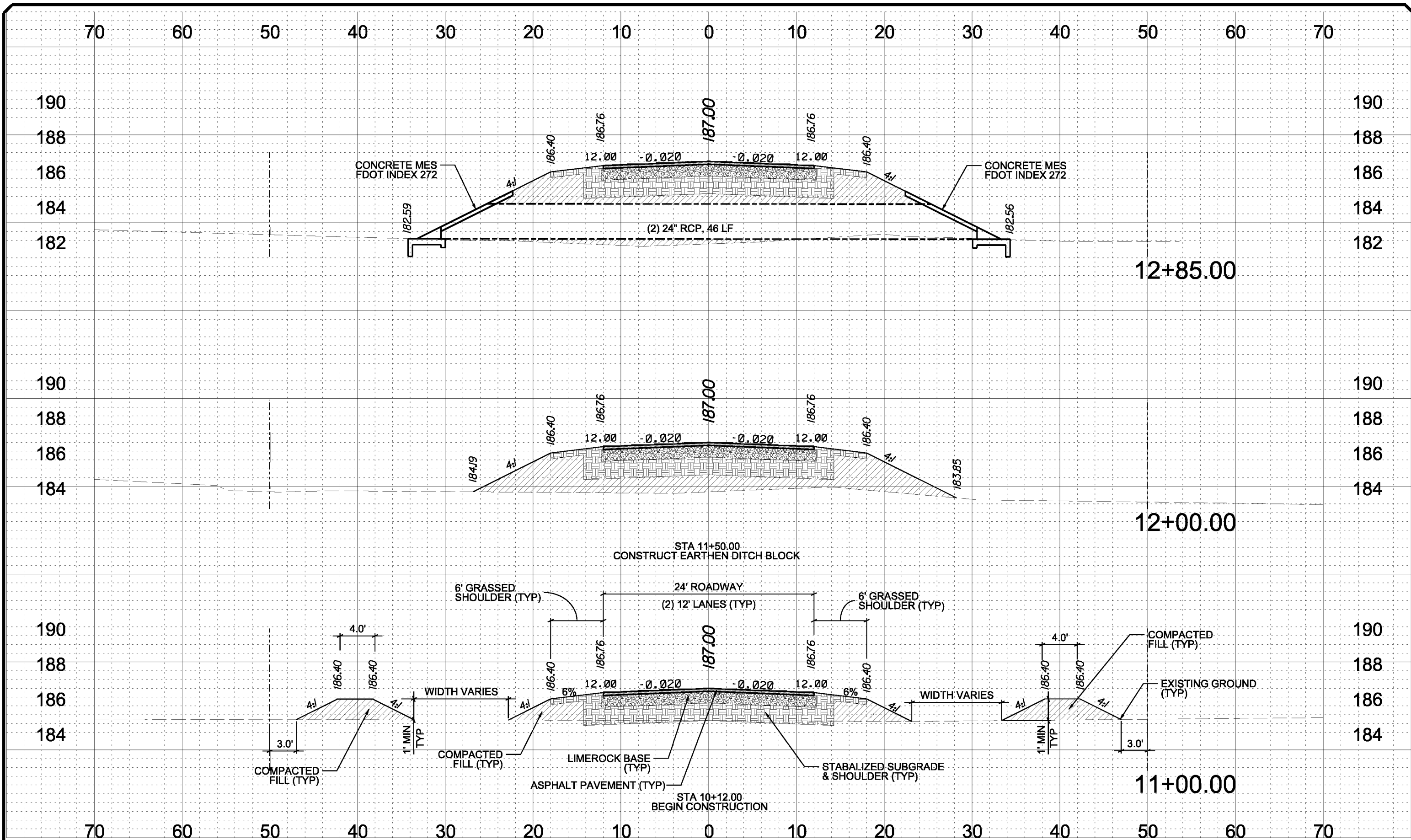

REVISIONS					
DATE	BY	DESCRIPTION	DATE	BY	DESCRIPTION

CES
Crews Engineering Services, LLC

CERTIFICATE OF AUTHORIZATION
NO. 28022
P.O. BOX 970
LAKE CITY, FL 32056
PHONE: 386.754.4085

DRAWN BY:
BC

APPROVED BY:
BC

Brett A. Crews, P.E. 65592

**PCWTP
NEW ACCESS ROAD**

CROSS SECTIONS

CES PROJECT NO.:
2012-002

SHEET:
XSC1

70 60 50 40 30 20 10 0 10 20 30 40 50 60 70

STA 16+40.00
CONSTRUCT EARTHEN DITCH BLOCK
STA 16+40.00
BEGIN BERM AT 3' FROM RIGHT OF WAY

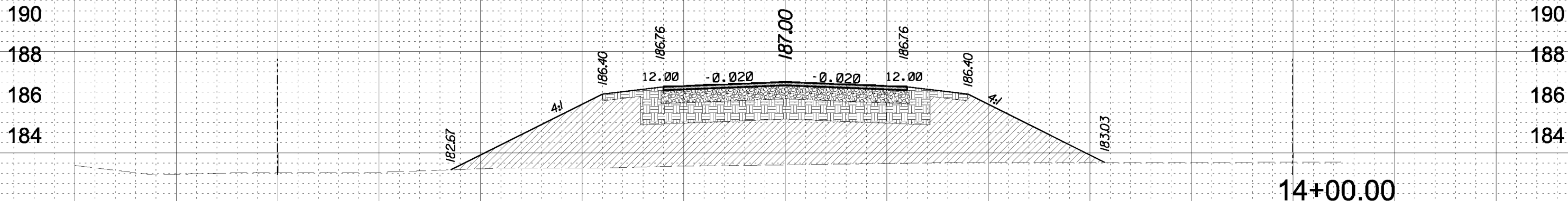
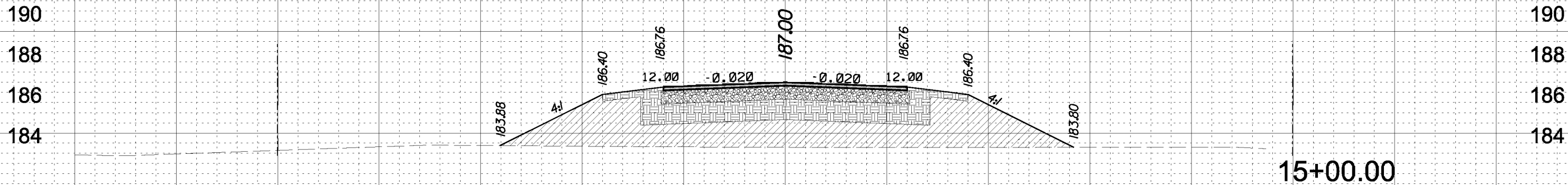
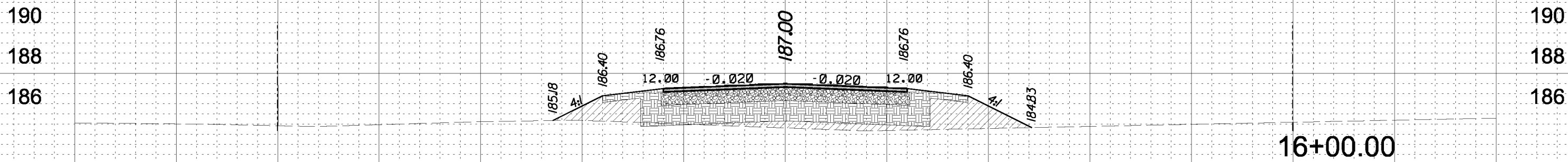

70 60 50 40 30 20 10 0 10 20 30 40 50 60 70

REVISIONS					
DATE	BY	DESCRIPTION	DATE	BY	DESCRIPTION



CERTIFICATE OF AUTHORIZATION
NO. 28022
P.O. BOX 970
LAKE CITY, FL 32056
PHONE: 386.754.4085

Brett A. Crews, P.E. 65592

DRAWN BY:
BC
APPROVED BY:
BC

**PCWTP
NEW ACCESS ROAD**
CROSS SECTIONS

CES PROJECT NO.:
2012-002
SHEET:
XSC2

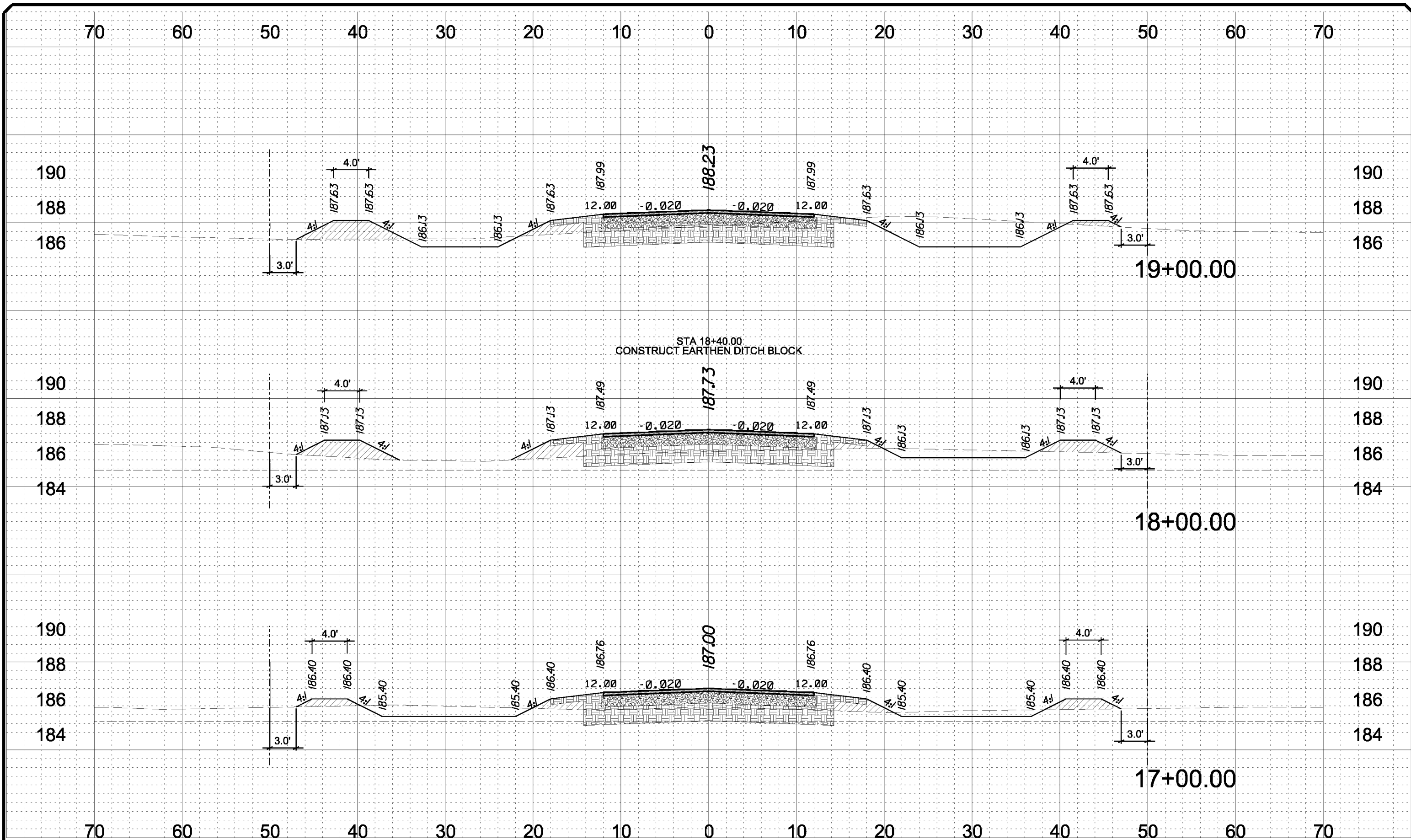

REVISIONS					
DATE	BY	DESCRIPTION	DATE	BY	DESCRIPTION

CES
 Crews Engineering Services, LLC

CERTIFICATE OF AUTHORIZATION
 NO. 28022
 P.O. BOX 970
 LAKE CITY, FL 32056
 PHONE: 386.754.4085

Brett A. Crews, P.E. 65592

DRAWN BY:
BC

APPROVED BY:
BC

**PCWTP
NEW ACCESS ROAD**

CROSS SECTIONS

CES PROJECT NO.:
2012-002

SHEET:
XSC3

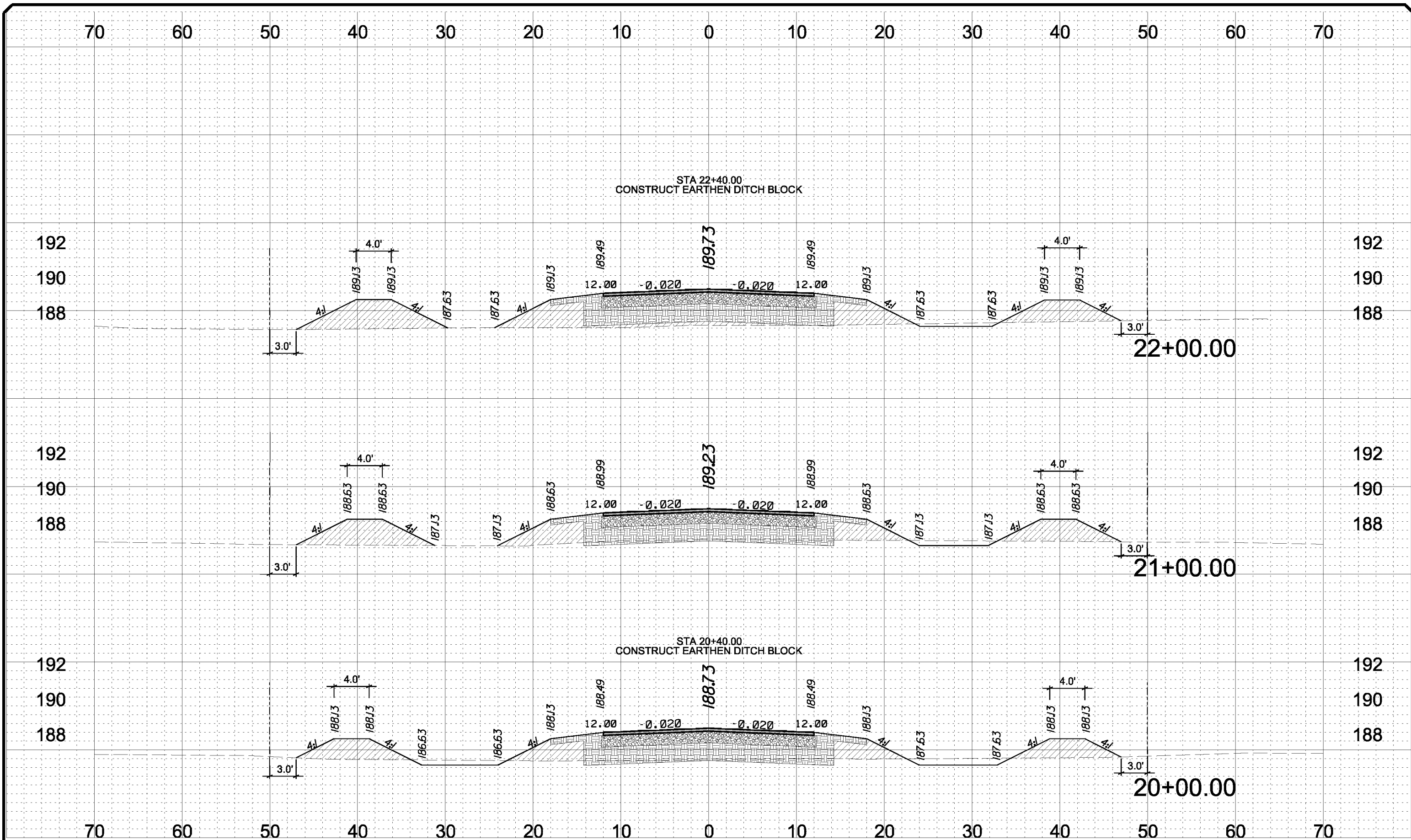

REVISIONS					
DATE	BY	DESCRIPTION	DATE	BY	DESCRIPTION

CES
 Crews Engineering Services, LLC

CERTIFICATE OF AUTHORIZATION
 NO. 28022
 P.O. BOX 970
 LAKE CITY, FL 32056
 PHONE: 386.754.4085

Brett A. Crews, P.E. 65592

DRAWN BY:
BC
APPROVED BY:
BC

**PCWTP
NEW ACCESS ROAD**

CROSS SECTIONS

CES PROJECT NO.:
2012-002
SHEET:
XSC4

70 60 50 40 30 20 10 0 10 20 30 40 50 60 70

194

194

192

192

190

190

188

188

STA 24+76.85
END CONSTRUCTION

194

194

192

192

190

190

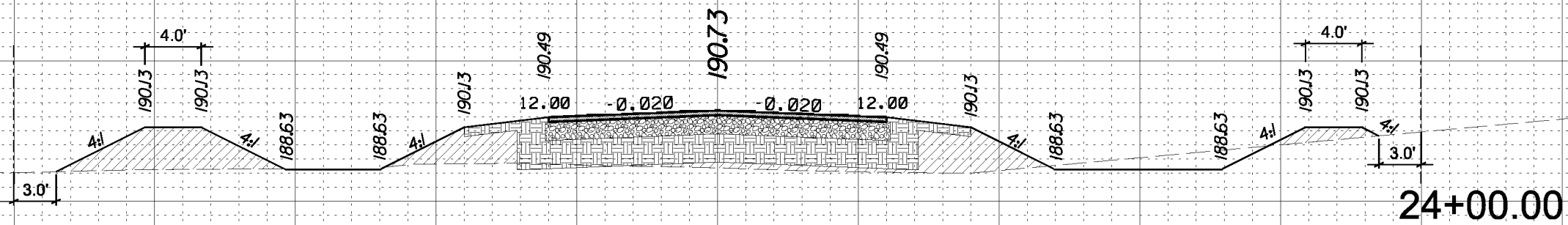

24+00.00

192

192

190

190

188

188

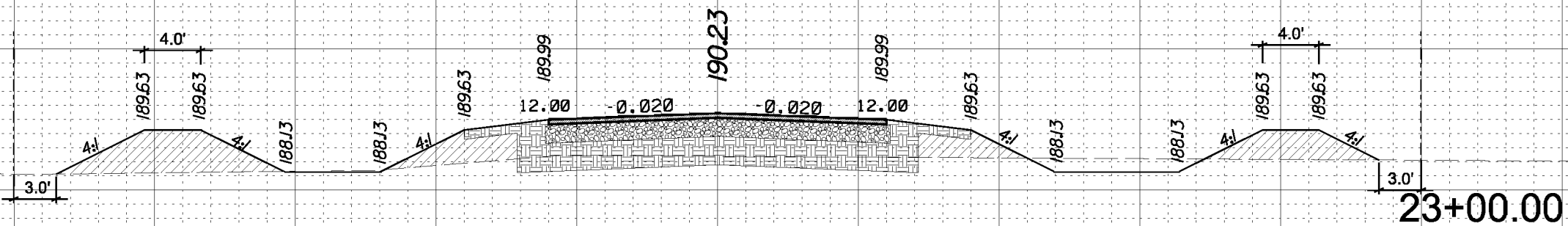

23+00.00

70 60 50 40 30 20 10 0 10 20 30 40 50 60 70

REVISIONS

DATE	BY	DESCRIPTION	DATE	BY	DESCRIPTION



CERTIFICATE OF AUTHORIZATION
NO. 28022

P.O. BOX 970
LAKE CITY, FL 32056
PHONE: 386.754.4085

Brett A. Crews, P.E. 65592

DRAWN BY:

BC

APPROVED BY:

BC

**PCWTP
NEW ACCESS ROAD**

CROSS SECTIONS

CES PROJECT NO.:

2012-002

SHEET:

XSC5

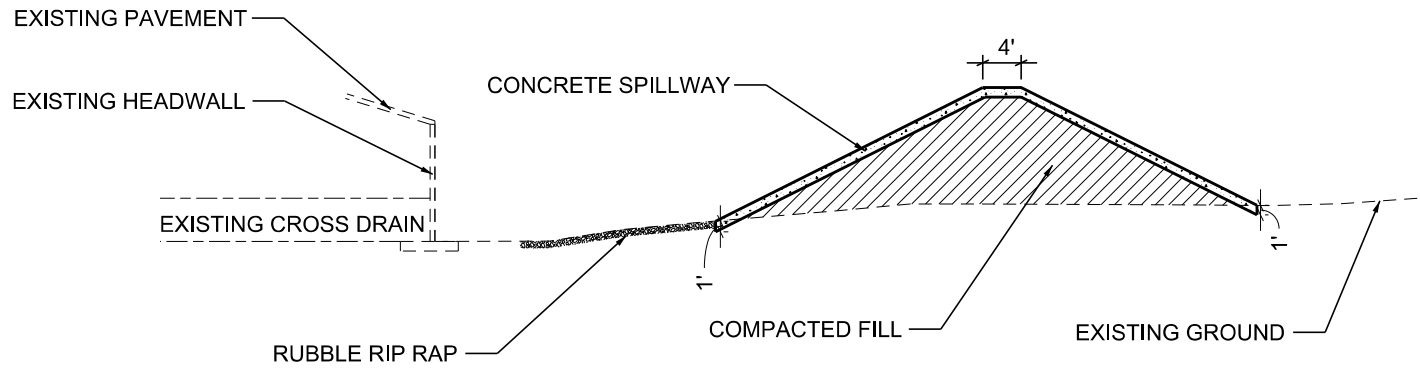
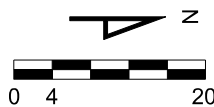
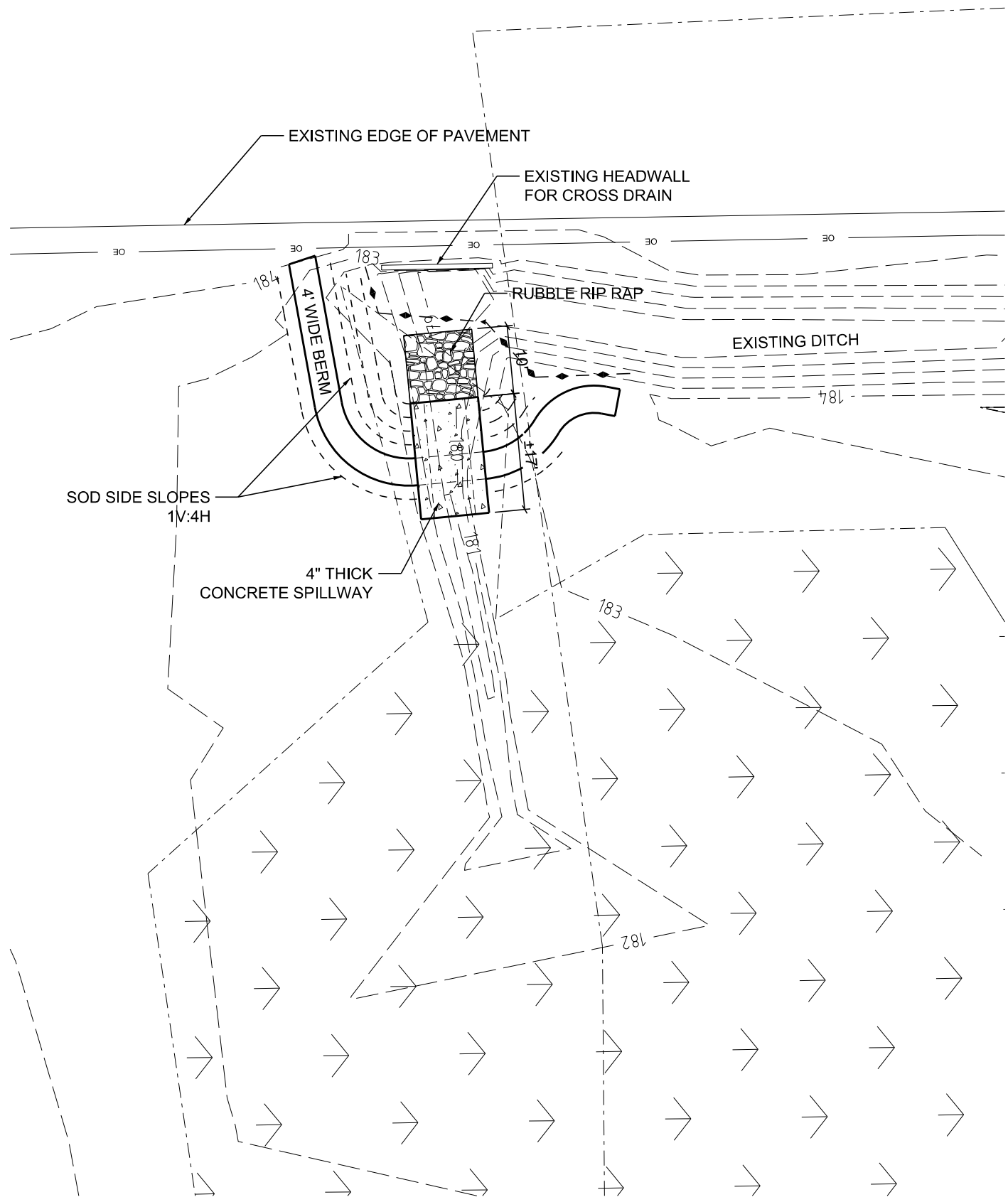

BERM CROSS SECTION
NTS

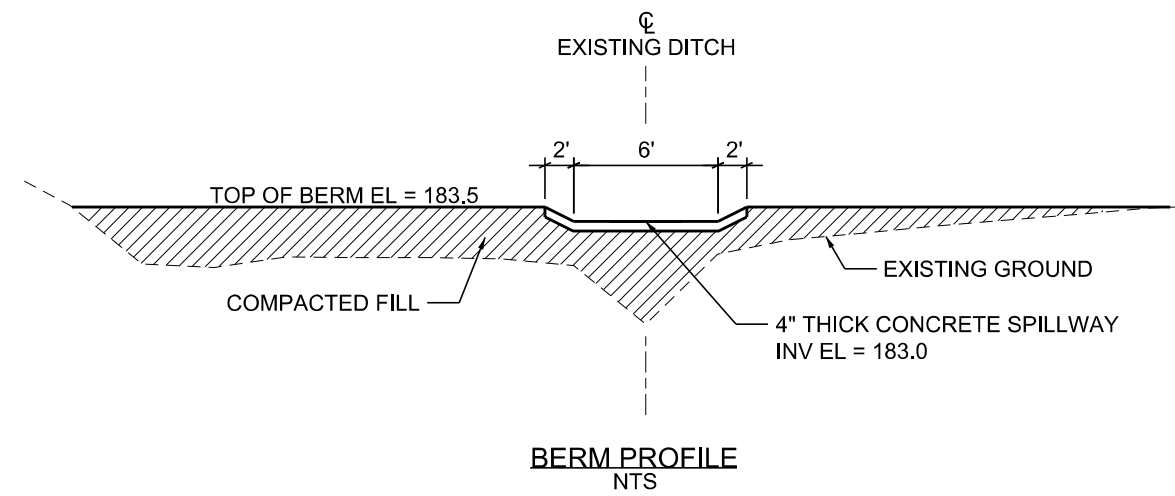

BERM PROFILE
NTS

REVISIONS

DATE	BY	DESCRIPTION	DATE	BY	DESCRIPTION



CERTIFICATE OF AUTHORIZATION
NO. 28022
P.O. BOX 970
LAKE CITY, FL 32056
PHONE: 386.754.4085

Brett A. Crews, P.E. 65592

DRAWN BY:
BC
APPROVED BY:
BC

**PCWTP
NEW ACCESS ROAD**
**WETLAND IMPROVEMENT
PLAN**

PROJECT NO.:
2012-002
SHEET:
WET1

I. INTRODUCTION

THIS DOCUMENT WAS PREPARED IN ORDER TO ILLUSTRATE COMPLIANCE WITH CHAPTER 62-621.300 (4) OF THE FLORIDA ADMINISTRATIVE CODE, WHICH PERTAINS TO THE GENERIC PERMIT FOR STORM WATER DISCHARGE FROM LARGE AND SMALL CONSTRUCTION ACTIVITIES. THE ADMINISTRATIVE CODE GRANTS THE FLORIDA DEPARTMENT OF ENVIRONMENTAL PROTECTION (FDEP) THE AUTHORITY TO REGULATE POINT SOURCE DISCHARGE OF STORM WATER FROM CONSTRUCTION SITES. THIS DOCUMENT ESTABLISHES A STORM WATER POLLUTION PREVENTION PLAN FOR THE SITE AND IS ORGANIZED TO CORRESPOND TO PART V OF DEP DOCUMENT NO. 62-621.300 (4) (a). FDEP FORM 62-621.300 (4) (b) IS TO BE SUBMITTED IN CONJUNCTION WITH THIS DOCUMENT.

II. SITE DESCRIPTION

COUNTY: LAKE CITY, FLORIDA
 SECTION/ TOWNSHIP/RANGE: SECTION 1, TOWNSHIP 4S, RANGE 17 EAST
 COUNTY PARCEL NO.: 8449-000
 STREET ADDRESS: LOCATED OFF OF TIMBERWOLF DRIVE TO TIE INTO WATER PLANT ROAD

A. NATURE OF CONSTRUCTION ACTIVITY

THE PROPOSED PROJECT CONSISTS OF CONSTRUCTING A NEW 24' WIDE ACCESS ROAD.

B. SEQUENCE OF MAJOR SOIL DISTURBING ACTIVITIES

1. PRIOR TO CONSTRUCTION, SILT FENCING AND TREE PROTECTION FENCING SHALL BE INSTALLED IN ACCORDANCE WITH THE STATE OF FLORIDA EROSION AND SEDIMENT CONTROL DESIGNER AND REVIEW MANUAL FOUND AT THE FOLLOWING WEB ADDRESS:
<http://www.dep.state.fl.us/water/nonpoint/docs/erosion/erosion-inspectors-manual.pdf>
2. IF SUITABLE, THE EXCAVATED SOIL MAY BE USED AS FILL FOR ONSITE GRADING THAT IS DEPICTED IN THE CONSTRUCTION DRAWINGS. CONTRACTOR SHALL DISPOSE OF ALL UNSUITABLE SOIL MATERIAL ONSITE OR OFFSITE TO A PERMITTED LOCATION.
3. THE SITE SHALL BE CLEARED AND GRUBBED OF UNWANTED VEGETATION.
4. ALL DISTURBED AREAS WITHIN THE CONSTRUCTION AREA SHALL BE COMPLETELY GRASSED AND/OR LANDSCAPED. GRASS SEEDING RATES AND MIXTURES SHALL BE PER THE FDOT STANDARD SPECIFICATION SECTION 570. EVIDENCE OF GROWTH MUST BE PRESENT PRIOR TO REMOVAL OF SILT FENCING AND OTHER EROSION CONTROL APPLICATIONS.

C. SITE DEVELOPMENT DATA:

TOTAL SITE AREA: 3.31 Ac
 IMPERVIOUS AREA: .88 Ac
 TOTAL RETENTION AREA (ON-SITE): .42 Ac
 TOTAL OPEN AREA (INCLUDES STORMWATER MANAGEMENT FACILITY AREAS): 3.0 Ac

D. SOIL CONDITIONS & STORM WATER QUALITY

NA

E. SITE MAP

SEE COVER SHEET FOR LOCATION MAP

F. STORM WATER OUTFALL LOCATION & RECEIVING WATER BODY

TOPOGRAPHY OF THE SURROUNDING LAND GENERALLY FLOWS SOUTHEAST TOWARD FALLING CREEK

III. CONTROLS TO REDUCE POLLUTION

ALL CONSTRUCTION ACTIVITIES SHALL BE CONDUCTED IN A MANNER AS TO NOT VIOLATE STATE WATER QUALITY STANDARDS. PRIOR TO CONSTRUCTION, THE CONTRACTOR SHALL IMPLEMENT AND MAINTAIN ALL EROSION AND SEDIMENT CONTROL MEASURES REQUIRED TO RETAIN SEDIMENT ONSITE. IF SITE CONDITIONS ARE SUCH THAT ADDITIONAL CONTROL MEASURES ARE REQUIRED OTHER THAN WHAT IS SPECIFIED IN THE EROSION AND SEDIMENTATION CONTROL PLAN, THEN THE CONTRACTOR SHALL IMPLEMENT ADDITIONAL BEST MANAGEMENT PRACTISES. SECTION IV BELOW PROVIDES DETAILS ON THE SPECIFIC CONTROL MEASURES TO REDUCE STORM WATER POLLUTION.

IV. EROSION & SEDIMENT CONTROL

A. STABILIZATION PRACTICES

ALL DRAINAGE STRUCTURES SHALL HAVE EROSION AND SEDIMENT CONTROL PER THE STATE OF FLORIDA EROSION AND SEDIMENT CONTROL DESIGNER AND REVIEW MANUAL. STABILIZATION MEASURES SHALL BE INITIATED FOR EROSION AND SEDIMENT CONTROL ON DISTURBED AREAS AS SOON AS PRACTICAL, BUT IN NO CASES MORE THAN 7 DAYS AFTER CONSTRUCTION IN THOSE AREAS HAS TEMPORARILY OR PERMANENTLY CEASED. GRASS SEEDING RATES AND MIXTURES SHALL BE PER THE FDOT STANDARD SPECIFICATION SECTION 570. EVIDENCE OF GROWTH MUST BE PRESENT PRIOR TO FINAL RELEASE.

B. STRUCTURE PRACTICES

AS DEPICTED IN THE PLANS, THE STORM WATER MANAGEMENT SYSTEM WILL CONSIST OF OPEN ROADSIDE DITCHES, EARTHEN DITCH BLOCKS AND PIPE CULVERTS. ALL EXISTING STORM DRAINS AND DRAINAGE SWALES SHALL BE PROTECTED ACCORDING TO THE STATE OF FLORIDA EROSION AND SEDIMENT CONTROL DESIGNER AND REVIEW MANUAL UNTIL CONSTRUCTION IS COMPLETE.

C. DRAINAGE LOCATIONS THAT SERVE AREAS WITH LESS THAN 10 DISTURBED ACRES

AS SPECIFIED IN THE "SEQUENCE OF MAJOR SOIL DISTURBING ACTIVITIES," THE SITE'S SWALES WILL BE CONSTRUCTED PRIOR TO CONSTRUCTION OF PAVEMENT. THE TOTAL CONTRIBUTING DRAINAGE AREA TO STORM WATER MANAGEMENT SYSTEMS IS LESS THAN 10 ACRES. THEREFORE, NO ADDITIONAL SEDIMENT TRAP BASINS ARE NECESSARY TO PROVIDE SEDIMENT STORAGE ONSITE DURING CONSTRUCTION. BY COMPLETION OF CONSTRUCTION, SWALES AND ALL DISTURBED AREAS SHALL BE STABILIZED WITH GRASS AND LANDSCAPING AS SPECIFIED ON THE CONSTRUCTION DRAWINGS.

D. DRAINAGE LOCATIONS THAT SERVE AREAS WITH MORE THAN 10 DISTURBED ACRES

NA

V. STORM WATER MANAGEMENT

A. BEST MANAGEMENT PRACTICES

AS REQUIRED PER THE STATE OF FLORIDA EROSION AND SEDIMENT CONTROL DESIGNER AND REVIEW MANUAL

B. VELOCITY DISSIPATION DEVICES

AS SHOWN ON PLANS. CONCRETE FLUME, SWALE AND PIPE OUTFALLS USE ENERGY DISSIPATION DEVICES NECESSARY DUE TO DISCHARGE VELOCITIES.

VI. CONTROLS FOR OTHER POTENTIAL POLLUTANTS

A. WASTE DISPOSAL

THE CONTRACTOR SHALL PROVIDE LITTER COLLECTION CONTAINERS WITHIN THE PROJECT BOUNDARIES DURING CONSTRUCTION. CONTRACTOR SHALL DISPOSE OF ALL UNSUITABLE MATERIALS AND CONSTRUCTION DEBRIS IN ACCORDANCE WITH ALL APPLICABLE LOCAL, STATE, AND FEDERAL REQUIREMENTS.

B. DUST CONTROL

N/A

C. EXISTING VERSUS PROPOSED POTABLE AND SANITARY SEWER SYSTEMS

N/A

D. FERTILIZER & PESTICIDES

THE USE OF FERTILIZERS AND PESTICIDES ON THE PROJECT SITE, WILL BE DIRECTED BY THE LANDSCAPE PLAN AND/OR THE FDOT STANDARD SPECIFICATION SECTION 982(7-1.7), TO SUPPORT THE GROWTH OF THE PROPOSED VEGETATION. ESTABLISHING THIS VEGETATION WILL AID IN THE STABILIZATION OF THE PROJECT SITE AND REDUCE EROSION. APPLICATIONS RATES FOR THE FERTILIZERS AND PESTICIDES SHALL BE IN ACCORDANCE WITH THE MANUFACTURERS RECOMMENDATIONS TO GUARD AGAINST OVER-USE, WHICH CAN LEAD TO VIOLATIONS OF STATE WATER QUALITY STANDARDS.

E. TOXIC MATERIAL

THE CONSTRUCTION SITE WILL BE IN FULL COMPLIANCE WITH STATE AND FEDERAL REQUIREMENTS. IN ADDITION, THE SITE SHALL BE IN COMPLIANCE WITH THE MORE STRINGENT COLUMBIA COUNTY HAZARDOUS MATERIALS MANAGEMENT CODES.

REVISIONS						 CES Crews Engineering Services, LLC	CERTIFICATE OF AUTHORIZATION NO. 28022 P.O. BOX 970 LAKE CITY, FL 32056 PHONE: 386.754.4085	DRAWN BY: BC APPROVED BY: BC	PROJECT NO.: 2012-002 SHEET: SWPPP 1
DATE	BY	DESCRIPTION	DATE	BY	DESCRIPTION				
							Brett A. Crews, P.E. 65592	PCWTP NEW ACCESS ROAD STORM WATER POLLUTION PREVENTION PLAN	

VII. APPROVED STATE & LOCAL PLANS

THE CONSTRUCTION DRAWINGS FOR THE PROJECT WERE APPROVED AND PERMITTED BY THE FOLLOWING AGENCIES:

SUWANNEE RIVER WATER MANAGEMENT DISTRICT, CITY OF LAKE CITY, AND COLUMBIA COUNTY

A. CONSTRUCTION ACTIVITY DISCHARGES

NA

B. CHANGES TO THE POLLUTION PREVENTION PLAN

THIS STORM WATER POLLUTION PREVENTION PLAN SHALL BE AMENDED TO REFLECT ANY APPLICABLE CHANGE IN A STATE, REGIONAL, OR LOCAL PERMIT FOR WHICH THE PERMITTEE RECEIVES WRITTEN NOTICE. WHEN WRITTEN NOTICE IS RECEIVED, THE PERMITTEE SHALL PROVIDE A RE-CERTIFICATION OF THIS POLLUTION PREVENTION PLAN, WHICH HAS BEEN REVISED TO ADDRESS SUCH CHANGES.

C. ALTERNATIVE PERMIT REQUIREMENTS

NO ALTERNATIVE PERMIT REQUIREMENTS ARE REQUESTED.

VIII. MAINTENANCE

THE CONTRACTOR IS RESPONSIBLE FOR THE MAINTENANCE, INSPECTION SCHEDULE, AND REPAIRS AS OUTLINED IN THIS PLAN. MAINTENANCE SHALL CONTINUE THROUGHOUT THE PROJECT UNTIL WORK IS COMPLETE. THE CONTRACTOR IS RESPONSIBLE FOR REMOVING ALL TEMPORARY EROSION AND SEDIMENT CONTROL DEVICES AFTER CONSTRUCTION IS COMPLETE. IN ADDITION TO THE TIMES MENTIONED IN THE PREVIOUS SECTIONS. THE CONTRACTOR SHALL INITIATE ANY REPAIRS WITHIN 24 HOURS OF BEING REPORTED. ACCUMULATED SEDIMENT SHALL BE REMOVED FROM SILT FENCING WHEN IT HAS REACHED ONE-FOURTH THE HEIGHT OF THE SILT FENCE.

IX. INSPECTIONS

THE CONTRACTOR SHALL INSPECT ALL POINTS OF POTENTIAL DISCHARGE FROM THE PROJECT SITE FOR ALL DISTURBED AREAS ON THE CONSTRUCTION SITE AT LEAST ONCE EVERY SEVEN CALENDAR DAYS AND WITHIN 24 HOURS OF THE END OF A STORM THAT IS GREATER THAN 0.50 INCHES. THE CONTRACTOR SHALL INSTALL A RAIN GAUGE AT THE SITE TO MONITOR AND DOCUMENT RAINFALL EVENTS IN EXCESS OF 0.50 INCHES. LOCATIONS WHERE THE SITE IS COMPLETELY CONSTRUCTED AND STABILIZED, SUCH INSPECTIONS SHALL BE CONDUCTED AT LEAST ONCE A MONTH. ALL INSPECTIONS SHALL BE RECORDED ON THE CONSTRUCTION INSPECTION FORM, A COPY OF WHICH MAY BE PROVIDED BY THE OWNER OR ENGINEER. MORE SPECIFICALLY, THE INSPECTION SHALL ENSURE THE FOLLOWING.

A. DISTURBED AREAS

ALL DISTURBED AREAS AND AREAS USED FOR MATERIAL STORAGE SHALL BE INSPECTED FOR POLLUTANTS ENTERING THE STORM WATER SYSTEM. THE STORM WATER MANAGEMENT SYSTEM AND EROSION AND SEDIMENT CONTROL MEASURES IDENTIFIED IN THE PLAN SHALL BE INSPECTED TO ENSURE THEY ARE OPERATING CORRECTLY. LOCATIONS WHERE VEHICLES ENTER AND EXIT THE SITE SHALL BE INSPECTED FOR EVIDENCE OF OFFSITE SEDIMENT TRACKING

B. MAINTENANCE PERFORMANCE

BASED ON THE RESULTS OF THE INSPECTION, ALL MAINTENANCE OPERATIONS NEEDED TO ASSURE PROPER COMPLIANCE WITH THIS PLAN SHALL BE DONE IN A TIMELY MANNER, BUT IN NO CASE LATER THAN 7 DAYS FOLLOWING THE INSPECTION.

C. REPORTING REQUIREMENTS

ALL INSPECTIONS SHALL BE RECORDED ON THE CONSTRUCTION INSPECTION FORM, A COPY OF WHICH MAY BE PROVIDED BY THE OWNER OR ENGINEER. THIS FORM IS CREATED TO SUMMARIZE THE SCOPE OF THE INSPECTION, THE NAME AND QUALIFICATION OF THE INSPECTOR, THE DATE OF INSPECTION, OBSERVATIONS, THE ACTIONS TAKEN TO CORRECT NONCOMPLIANCE WITH THE PROVISIONS OF THIS PLAN. THE PERMITTEE SHALL RETAIN ALL INSPECTION REPORTS FOR A PERIOD OF THREE YEARS FROM THE DATE WHEN CONSTRUCTION IS COMPLETE OR WHEN THE SITE IS COMPLETELY STABILIZED. A COPY OF THIS PLAN SHALL BE RETAINED AT THE CONSTRUCTION SITE FROM THE DATE OF PROJECT INITIATION TO THE DATE OF FINAL STABILIZATION.

X. NON-STORMWATER DISCHARGES

IN ADDITION TO STORM WATER RUNOFF, THIS PLAN APPLIES TO RUNOFF FROM IRRIGATION OPERATIONS AND CONSTRUCTION PRACTICES. THIS PLAN DOES NOT PERTAIN TO DISCHARGES FROM FIRE FIGHTING ACTIVITIES.

XI. CONTRACTORS CERTIFICATION

THE CONTRACTORS OR SUBCONTRACTORS SHALL COPY AND COMPLETE THE CERTIFICATION FORM (FDOT 650-040-07) . IT SHALL BE PROVIDED TO THE OWNER AND KEPT ON FILE PURSUANT TO SECTION XII REGARDING RETENTION RECORDS.

XII. RETENTION OF RECORDS

THE PERMITTEE IS REQUIRED TO RETAIN ALL REPORTS REQUIRED BY THIS PERMIT, INCLUDING SWPPP PLANS, AND RECORDS OF ALL DATES USED TO COMPLETE THE NOTICE OF INTENT (NOI) TO BE COVERED BY THIS PERMIT, FOR A PERIOD OF AT LEAST THREE (3) YEARS FROM THE DATE OF FINAL STABILIZATION.

XIII. NOTICE OF TERMINATION

NOTICE OF TERMINATION:

1. WHEN THE SITE HAS BEEN FINALLY STABILIZED AND ALL STORM WATER DISCHARGES FROM CONSTRUCTION SITES THAT ARE AUTHORIZED BY THIS PERMIT ARE ELIMINATED (SEE BELOW FOR THE DEFINITION OF FINAL STABILIZATION), THE PERMITTEE OF THE FACILITY SHALL SUBMIT A NOTICE OF TERMINATION, ON DEPARTMENT FORM 62-621.300(6), WITHIN 14 DAYS OF FINAL STABILIZATION OF THE SITE.
2. ELIMINATION OF STORM WATER DISCHARGES ASSOCIATED WITH CONSTRUCTION ACTIVITY MEANS THAT ALL DISTURBED SOILS AT THE IDENTIFIED FACILITY HAVE BEEN FINALLY STABILIZED AND TEMPORARY EROSION AND SEDIMENT CONTROL MEASURES HAVE BEEN REMOVED OR WILL BE REMOVED AT AN APPROPRIATE TIME, OR THAT ALL STORM WATER DISCHARGES ASSOCIATED WITH CONSTRUCTION ACTIVITIES FROM THE IDENTIFIED SITE THAT ARE AUTHORIZED BY THIS GENERIC PERMIT HAVE OTHERWISE BEEN ELIMINATED.

3. WHEN CONSTRUCTION AND FINAL STABILIZATION HAS BEEN COMPLETED AND ALL SEDIMENTATION CONTROL DEVICES HAVE BEEN REMOVED. THE PERMITTEE SHALL SUBMIT A NOTICE OF TERMINATION TO THE FOLLOWING ADDRESS:

NPDES STORM WATER NOTICES CENTER, MS# 2510
 FLORIDA DEPARTMENT OF ENVIRONMENTAL PROTECTION
 2600 BLAIR STONE ROAD
 TALLAHASSEE, FL 32399-2400

4. UPON SIGNIFICANT COMPLETION OF CONSTRUCTION, THE STORMWATER PIPING SYSTEM SHALL BE FLUSHED OUT TO REMOVE ACCUMULATED DEBRIS AND SEDIMENT. UPON COMPLETION OF THE DEBRIS AND SEDIMENT REMOVAL FROM THE STORMWATER PIPING SYSTEM, THE PROPOSED STORMWATER MANAGEMENT FACILITY(S) SHALL BE FINE GRADED AND BE EXCAVATED A MINIMUM OF SIX INCHES BELOW THE DESIGN BOTTOM ELEVATION AND REPLACED WITH FILL HAVING A PERMIABILITY RATE OF 20 FT/DAY WITH A MAXIMUM OF 5% SOIL FINES PASSING THE NO. 200 SIEVE. THE BOTTOM SHALL BE SCARIFIED AND STABILIZED ACCORDING TO THESE PLANS. ONCE COMPLETED, NO HEAVY MACHINERY SHALL BE ALLOWED WITHIN THE STORMWATER MANAGEMENT FACILITY(S).

REVISIONS

DATE	BY	DESCRIPTION	DATE	BY	DESCRIPTION



CERTIFICATE OF AUTHORIZATION
NO. 28022

P.O. BOX 970
LAKE CITY, FL 32056
PHONE: 386.754.4085

Brett A. Crews, P.E. 65592

DRAWN BY:

BC

APPROVED BY:

BC

PCWTP NEW ACCESS ROAD	PROJECT NO.:	2012-002
	STORM WATER POLLUTION PREVENTION PLAN	SHEET: SWPPP 2